

1

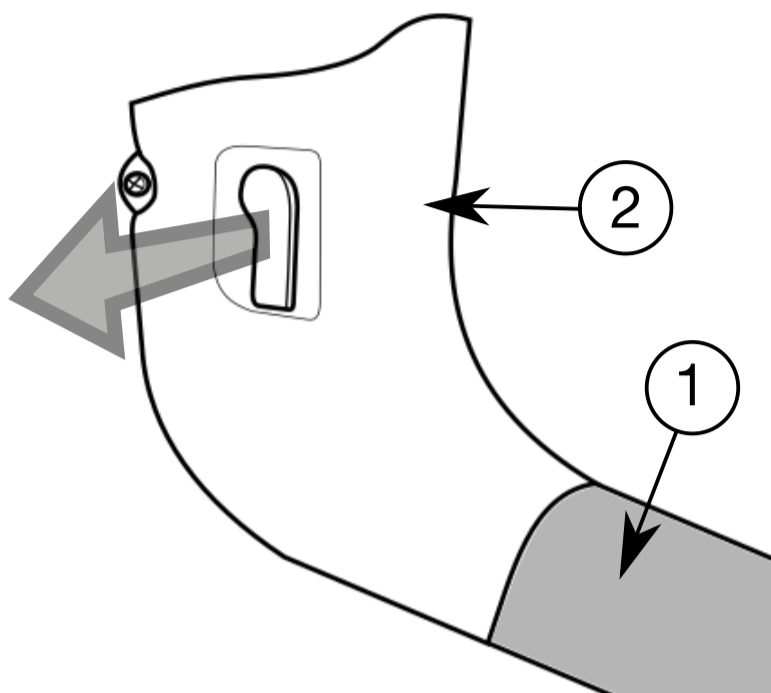

Remove driver's side scuff plate front (1) and cowl side trim (2)

Note - side trim has a clip forward that unscrews and the bonnet release handle requires a strong pull towards the centre of the vehicle to release.

2

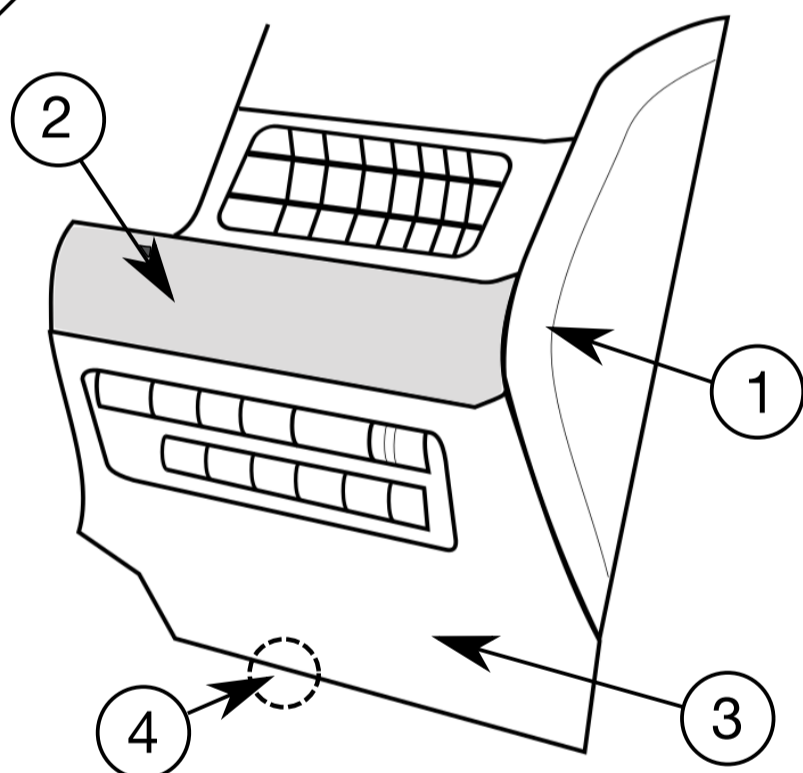

Remove driver's side trim in order:

- 1 - Instrument panel side cover
- 2 - Instrument panel pad
- 3 - Instrument lower panel assembly

Note - Item 3 has one screw fixing (4) indicated and requires a strong pull rearwards to release all the clips

3

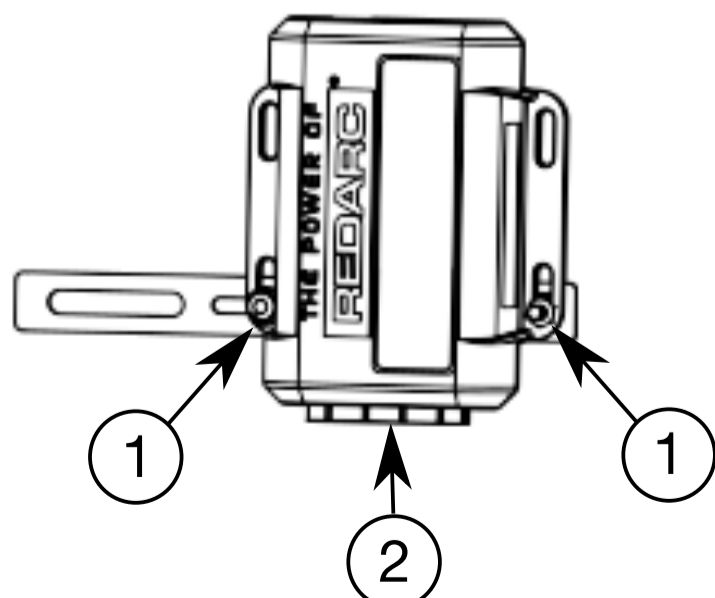

Secure the fixing bracket to the Main Unit as shown left, using the two M4 nuts, bolts and washers provided (1).

Note orientation - long slot in bracket is to the left at power connector end (2).

4

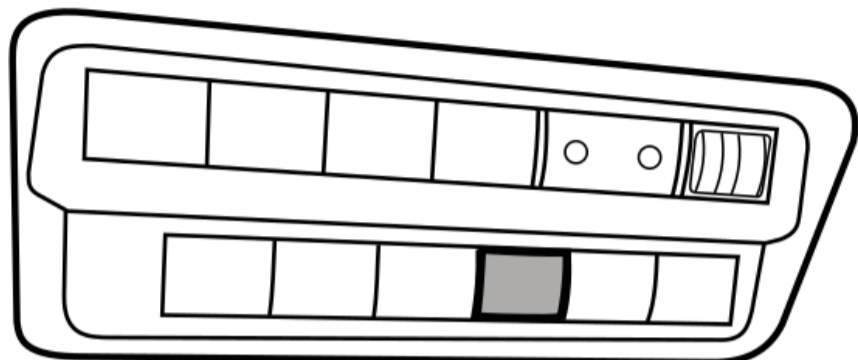

Remove spare switch blank (shaded) from panel removed in step 2. If the customer expresses an alternative, this is acceptable.

Fit supplied Remote Head (in matching switch insert) into location.

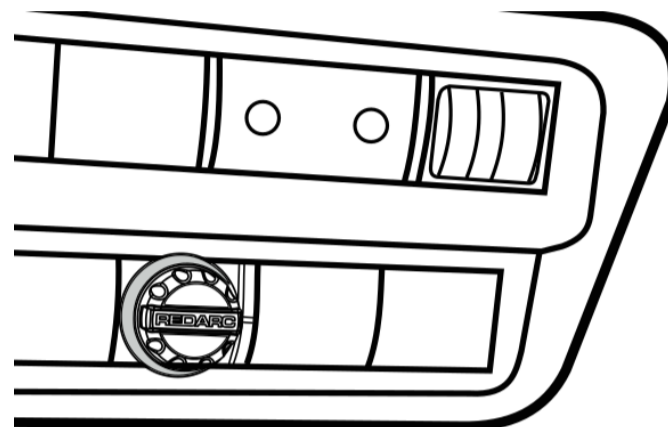

5

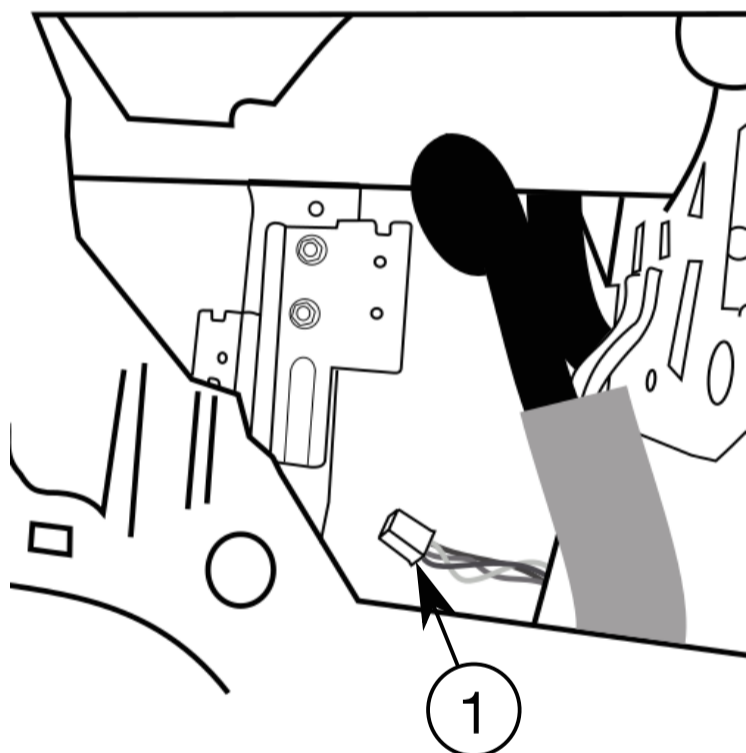

Under the steering column, locate the vehicle 4-way connector (1) (tucked in to vehicle harness to the right) and pull out to centre

Connect the supplied short Adaptor cable here.

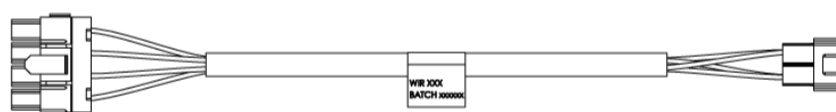

6

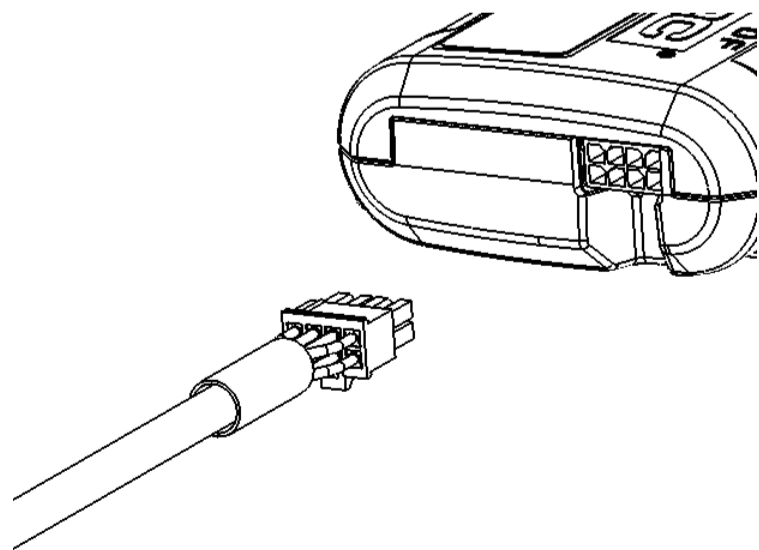

Connect the Remote Head cable to the Main Unit assembly in preparation for final fixing.

7

Secure Main Unit assembly to vehicle bracket at location indicated (1) using supplied M6 fixings.

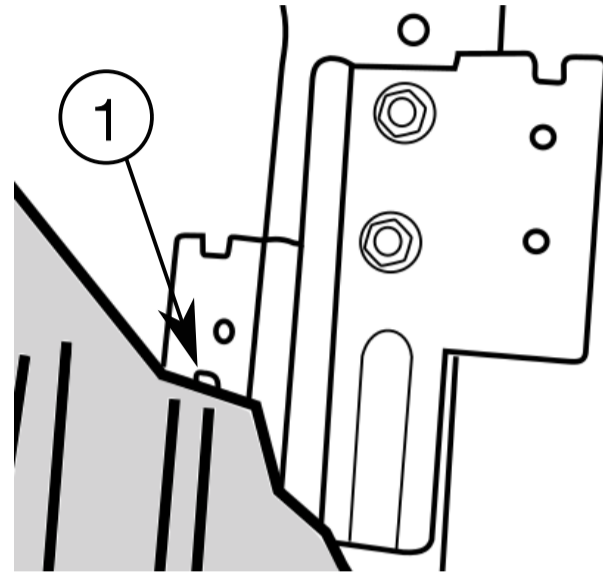
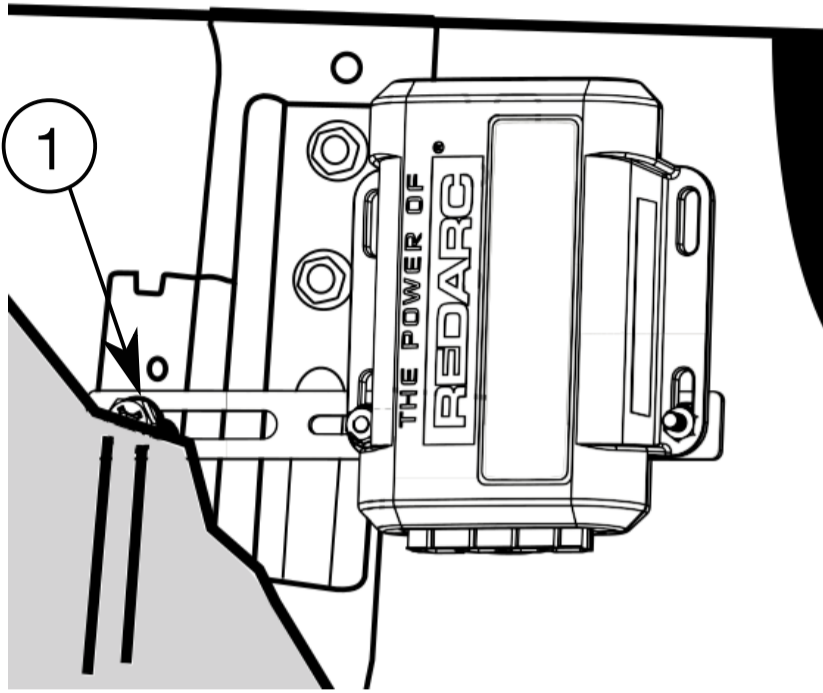

8

Connect Adaptor cable to main Unit and tidy up all wiring, securing to vehicle wiring using supplied cable ties.

Connect Remote Head Cable to rear of switch insert fitted in Step 4.

Refit all trim.

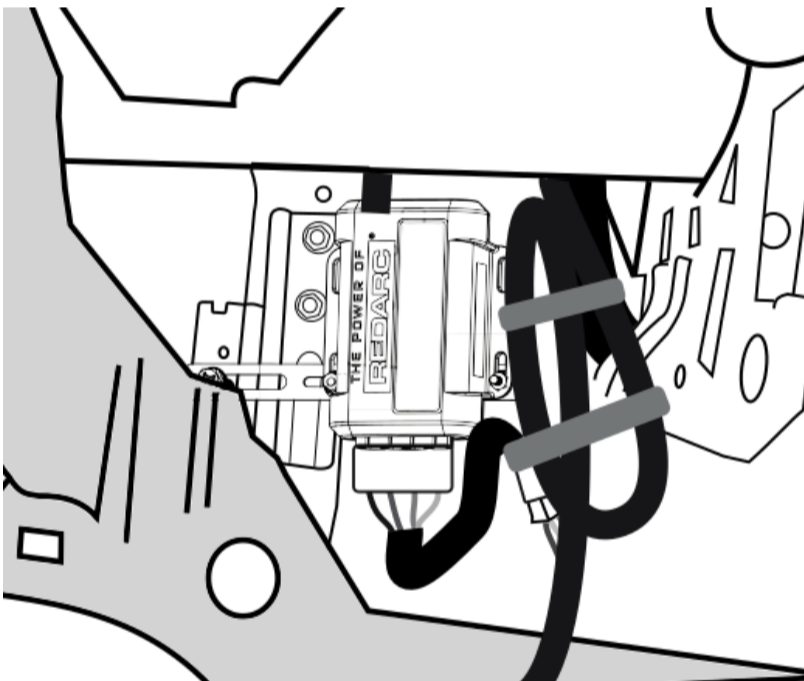

9

Test the connection of the Electric Brake Controller by connecting a test load (5W min - 21W max) to the 'Service Brake' connection on the Trailer socket (as indicated left).

The Remote Head will illuminate when connected correctly.

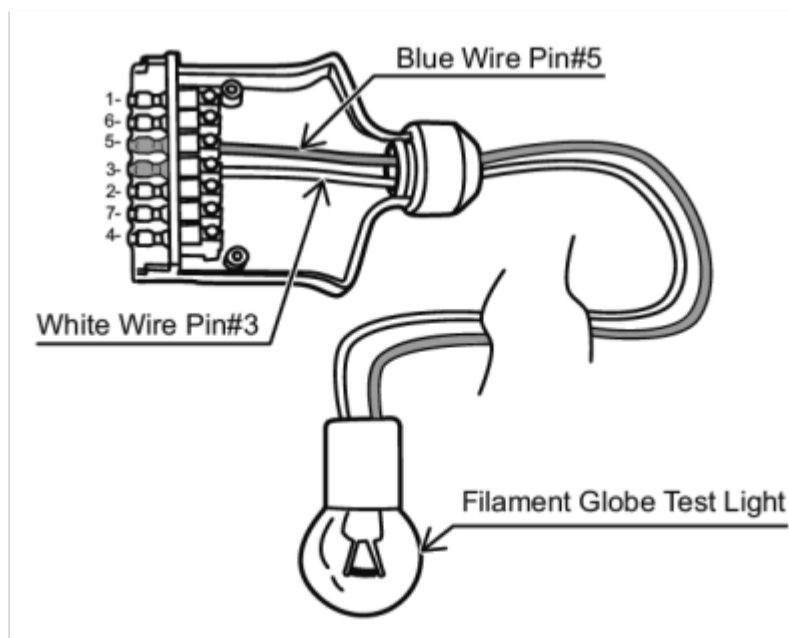

10

To confirm correct installation, perform a Mode Change - this can only be successful if power and brake sense are connected correctly

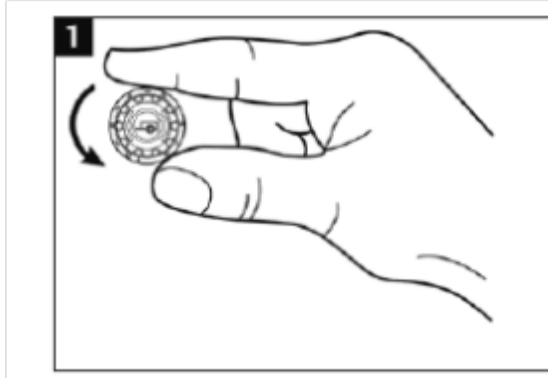

Rotate fully counter-clockwise to '0'

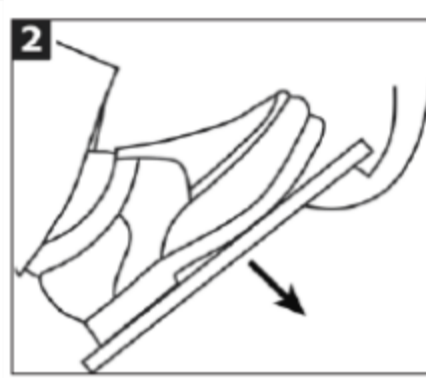

Apply and hold brake

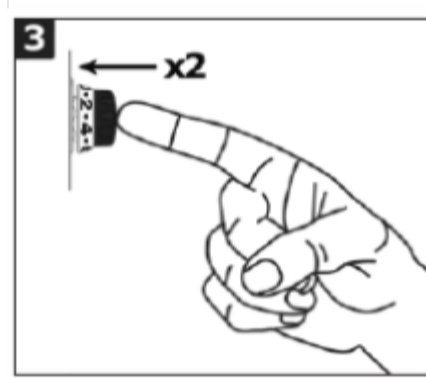

Double-press

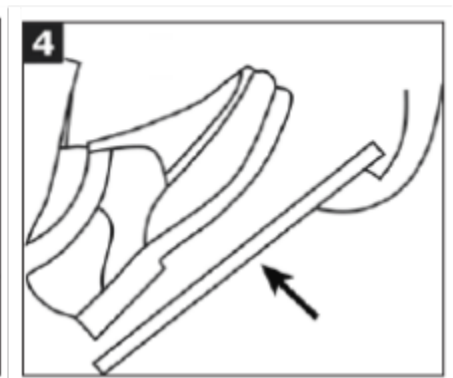

Release brake

Upon successful mode change, the Remote Head illumination will change from:
GREEN to BLUE (or GREEN/BLUE flashing) indicating **Proportional Mode**
BLUE (or GREEN/BLUE flashing) to GREEN indicating **User Controlled Mode**

*Ensure the system is in **Proportional Mode** (BLUE or GREEN/BLUE flashing) at end of test.*