

Remove driver's side scuff plate front (1) and cowl side trim (2)
Remove drivers side undercover (shown below)

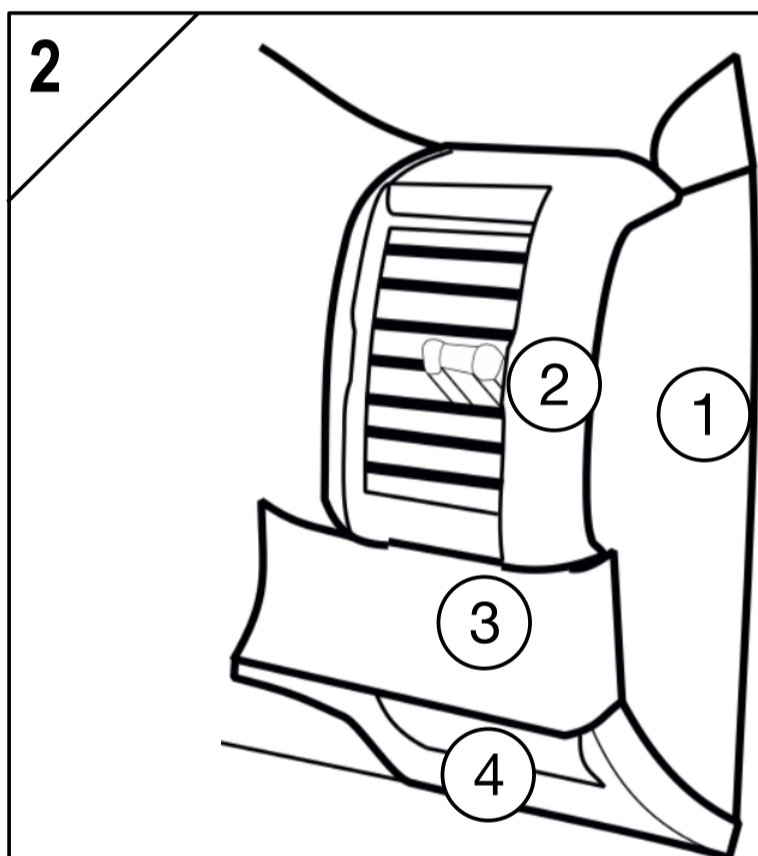

Remove driver's side trim in order:
1 - Instrument panel side cover
2 - Air Outlet Assembly
3 - Trim Assembly (remove screw exposed after removing item 2)
4 - Instrument lower panel assembly (remove both lower screw and screw exposed after removing item 3)

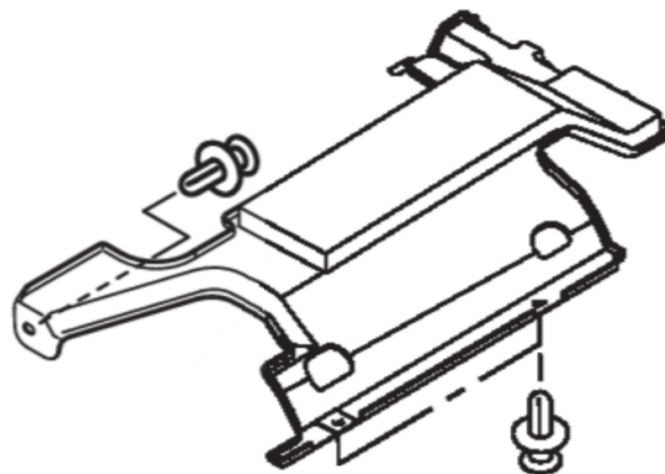
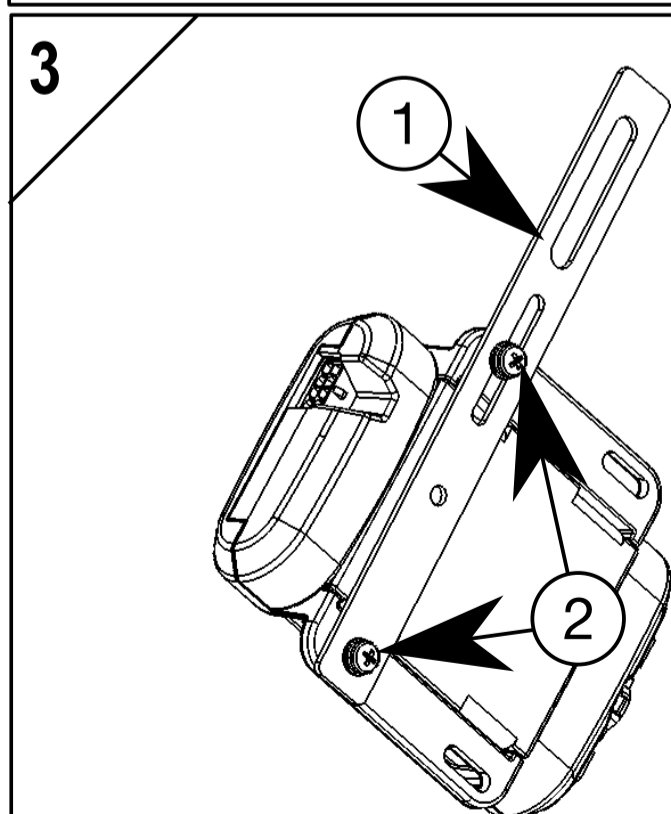

Secure the supplied fixing bracket (1) to the Main Unit as shown left, using the two M4 nuts, bolts and washers provided (1).
Note correct orientation of bracket and Main Unit
Bend bracket 90 degrees (down) as indicated below

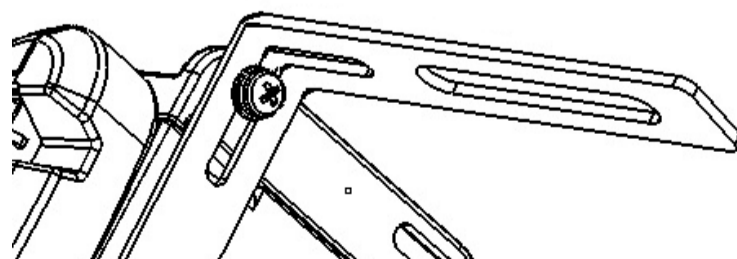

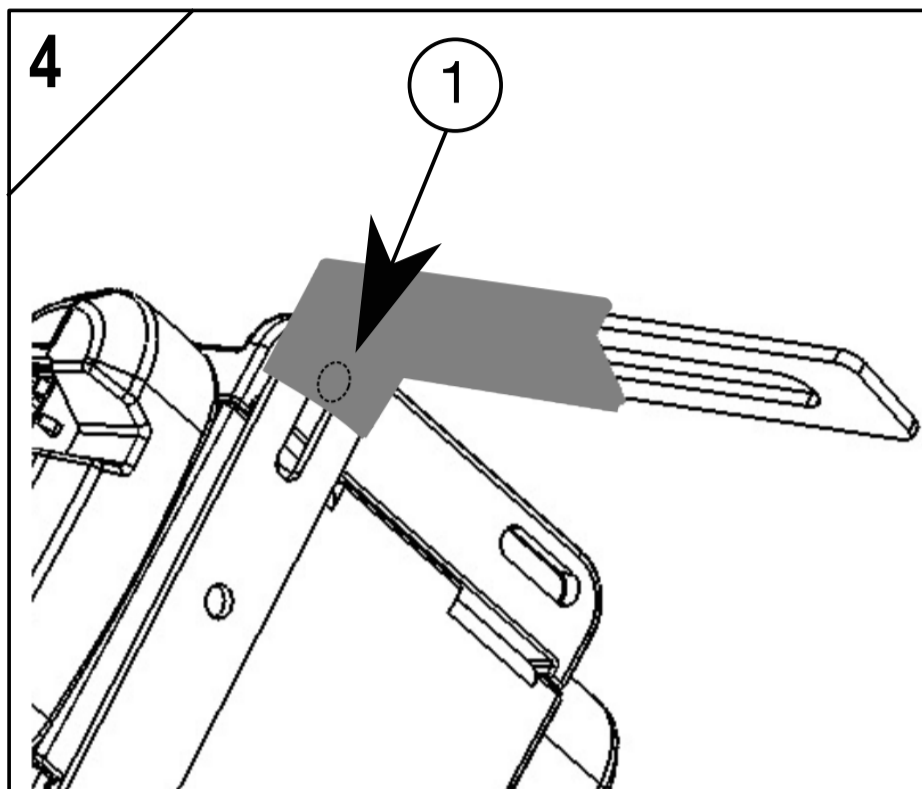

Wrap supplied adhesive foam pad around the bracket as shown left, ensuring you cover the fixing indicated (1)
Connect the Remote Head cable to the Main Unit assembly in preparation for final fixing, as shown below.

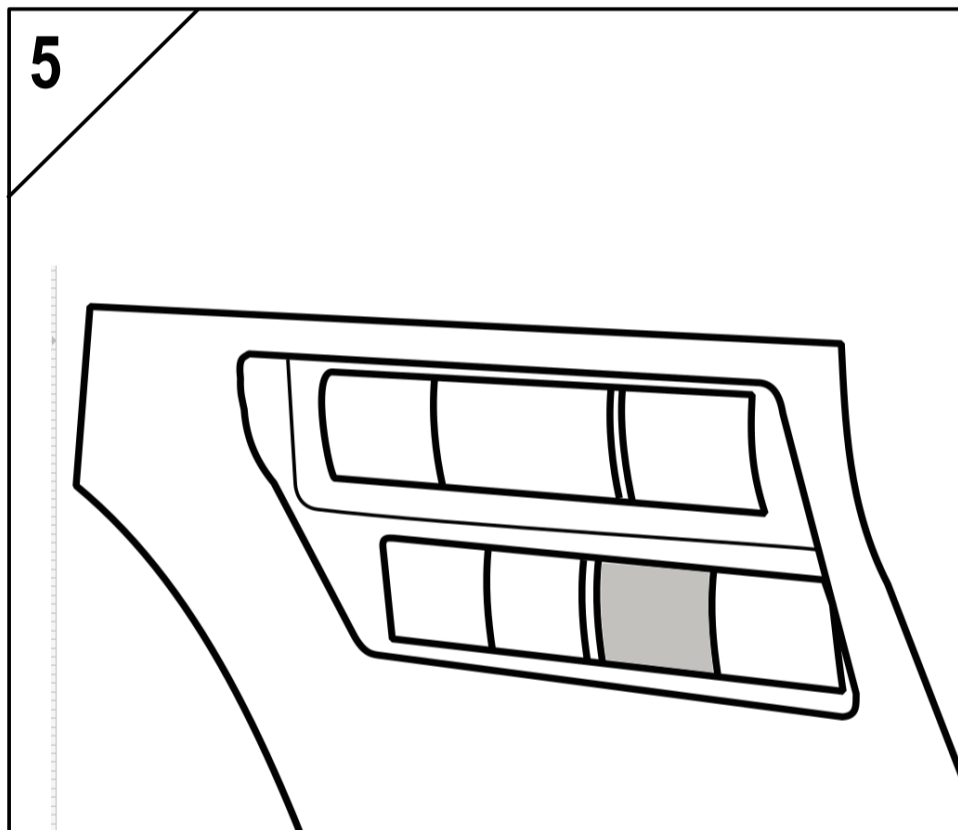
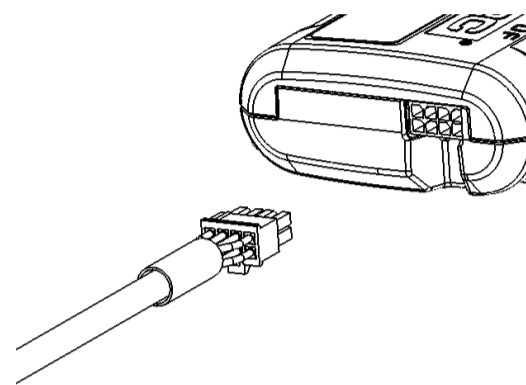

Remove spare switch blank (shaded) from panel removed in step 2. If the customer expresses an alternative, this is acceptable.
Fit supplied Remote Head (in matching switch insert) into location.

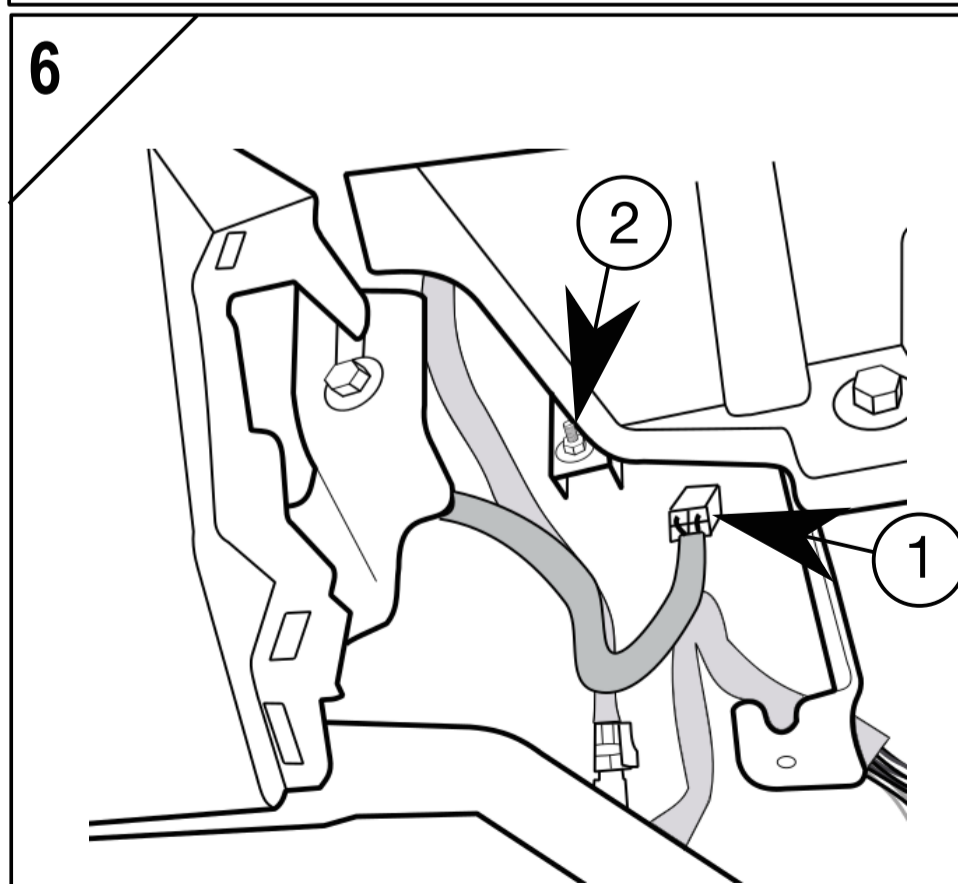

Under the steering column, locate the vehicle 4-way prepared connector (1) (part of kit MZ350775), matching the supplied adaptor cable (shown below)
Connect the supplied short Adaptor cable here. View is from driver footwell looking upwards and forwards.
Note location for main Unit fixing (2)

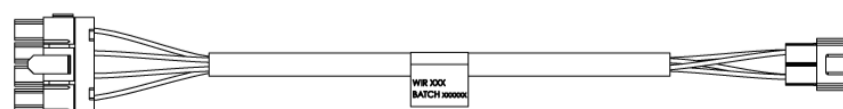

7

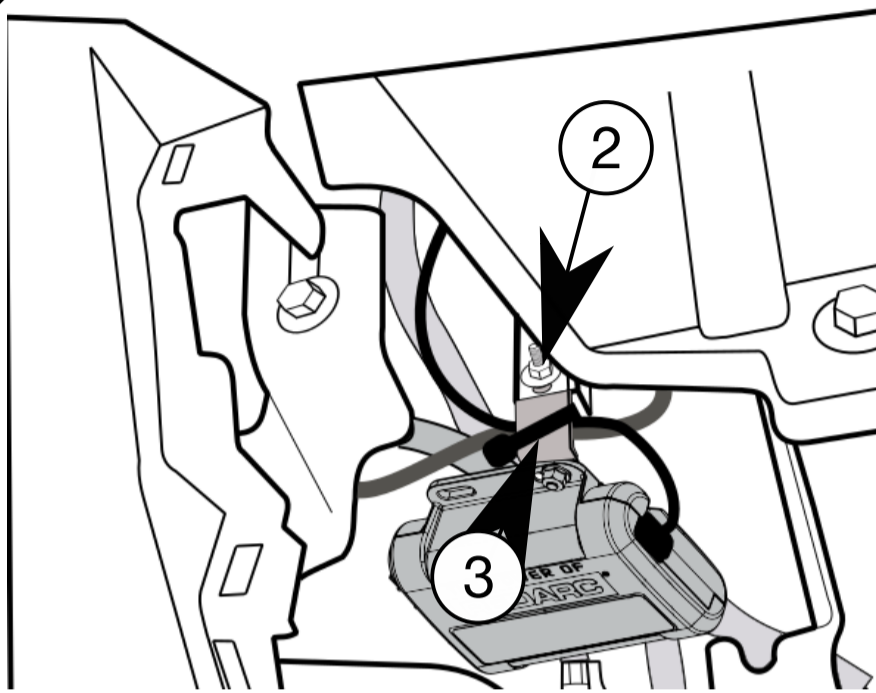

Connect the Adaptor Cable to the Main Unit.
Fit the Main Unit Assembly in position using the original vehicle fixing (identified in step 6) through the bracket slot.
Tidy up wiring - securing any loose with a cable tie around the bracket at the foam wrapped section (3)

8

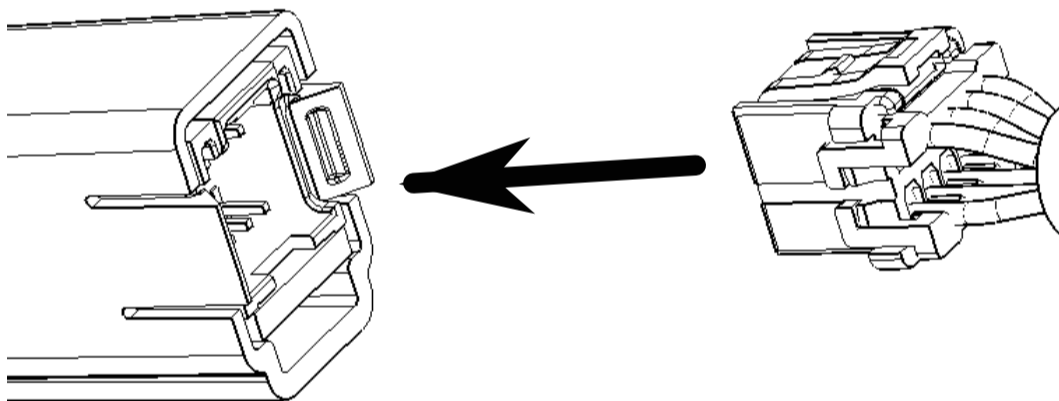

Connect Remote Head Cable to rear of switch insert (fitted in Step 5) whilst refitting all trim.

9

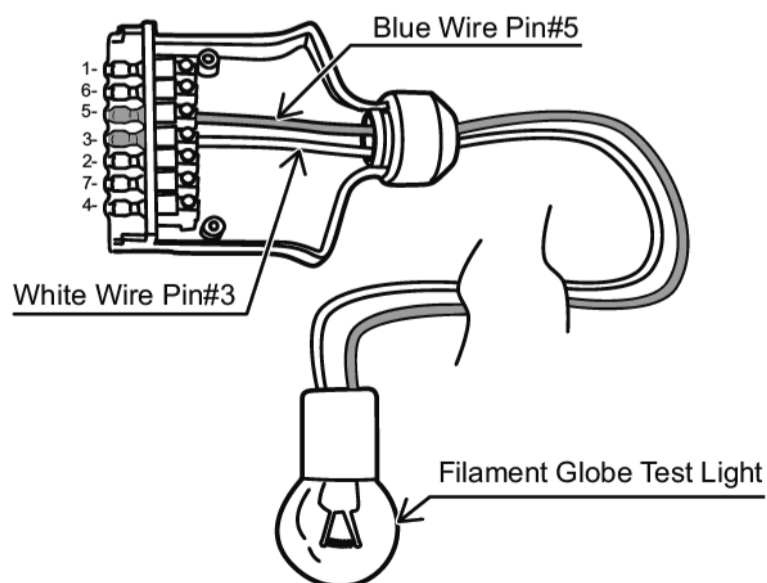

Test the connection of the Electric Brake Controller by connecting a test load (5W min - 21W max) to the 'Service Brake' connection on the Trailer socket (as indicated left).
The Remote Head will illuminate when connected correctly.

10

To confirm correct installation, perform a Mode Change - this can only be successful if power and brake sense are connected correctly

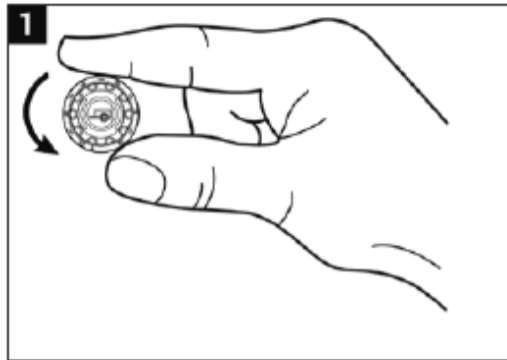

Rotate fully counter-clockwise to '0'

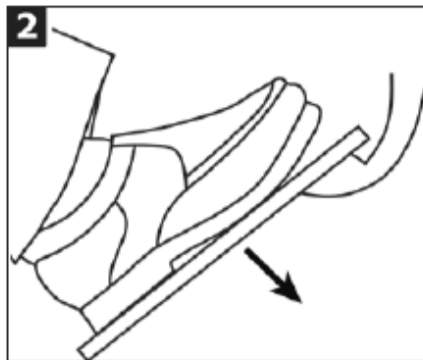

Apply and hold brake

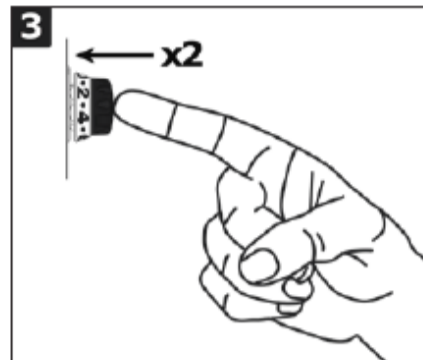

Double-press

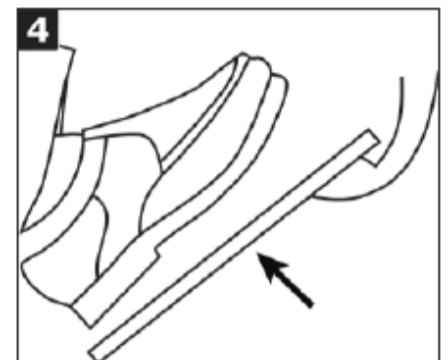

Release brake

Upon successful mode change, the Remote Head illumination will change from:

GREEN to BLUE (or GREEN/BLUE flashing) indicating *Proportional Mode*

BLUE (or GREEN/BLUE flashing) to GREEN indicating *User Controlled Mode*

Ensure the system is in Proportional Mode (BLUE or GREEN/BLUE flashing) at end of test.